

# Innovation, Preservation and Performance for Historic Results



Experience the unexpected with an architectural-grade, value-priced window with flexible options for a historic look. The strong lines of the new NX-300 Series Thermal Windows lend a historic appearance to projects, blending seamlessly with the architecture of older buildings. The windows come with a 3-1/4" depth frame and 2-5/8" sightline, and have been tested to U.S. and Canadian standards. With AAMA architectural grade ratings up to AW-PG90 on most common configurations, NX-300 Series Thermal Windows reach higher performance criteria than ever.

Ideal for the architectural details of historical window restorations on low- to mid- and high-rise commercial, education, multifamily and public projects, NX-300 Series Thermal Windows achieve the putty-glazed, beveled-sash window look. A variety of options allows for the

design and installation versatility for replacing existing wood or steel installations. Made from aluminum and designed for superior durability, NX-300 Series Thermal Windows are engineered to withstand extreme temperatures and conditions.

#### **VERSATILITY**

A variety of casement outswing, project-out (awning), fixed and fixed over project-out configurations are available to suit most applications. Units can be used in punched openings or be stacked vertically or horizontally. An assortment of structural mullions allows for larger unit configurations, while several options for anchoring methods, head and jamb receptors, sub-sills and panning types allow for installation flexibility.

**3-Piece Mullion Options**

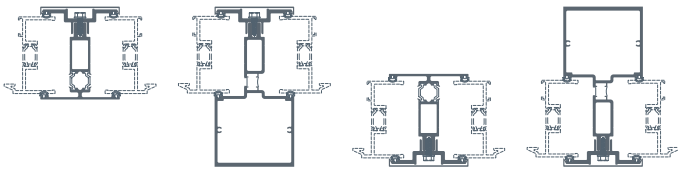

**Typical Panning Options**

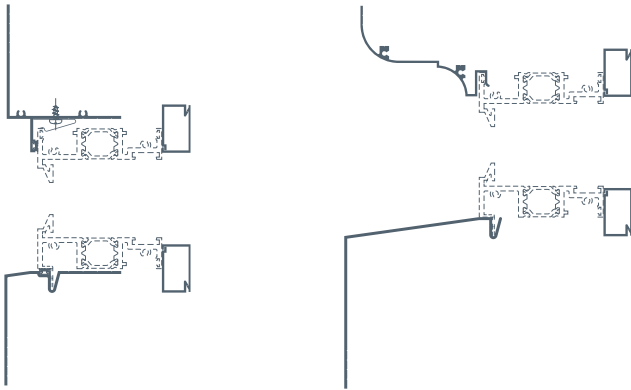

**PERFORMANCE**

NX-300 Series Thermal Windows deliver high thermal performance and minimized condensation with insulating glass options and polyamide thermal breaks, which increase occupant comfort and lower energy expenditures. A frame design with 0.125" wall thickness provides strength and minimal sightlines, while friction position corner keys provide accurate alignment throughout the window assemblies. The windows are tested in accordance with AAMA/WDMA/CSA 101/I.S. 2/ A440 NAFS – North American Fenestration Standard/Specification for windows, doors and skylights.

MODEL	AW RATING	FUNCTION
NX-310	AW-PG90-C	Outswing Casement
NX-350	AW-PG90-AP	Project-Out (Awning)
NX-380	AW-PG90-FW	Fixed Window

**FEATURES & AESTHETICS**

The NX-300 Series Thermal Window is packed with features that make installation easier and more economical, giving architects and design professionals the ability to create the appearance of historic structures with the modern performance of advanced window systems from a single-source supplier.

When a building needs to reflect a historic aesthetic yet operate with modern performance, NX-300 Series Thermal Windows from Kawneer are an excellent solution. Contact us today to learn more about how NX-300 Series Thermal Windows can deliver innovative preservation and performance for your next historic low- to mid- or high-rise project.

